

Contractor:

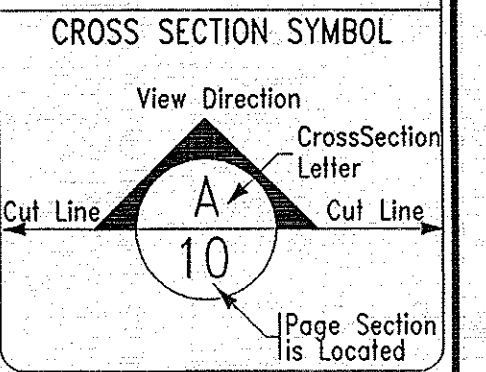

Stamp:

Notes:

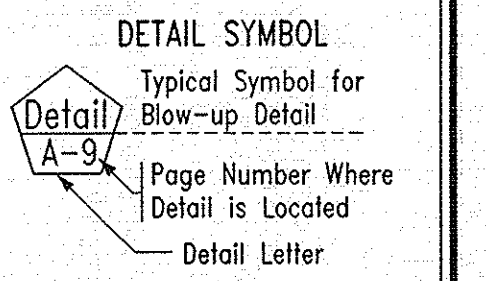
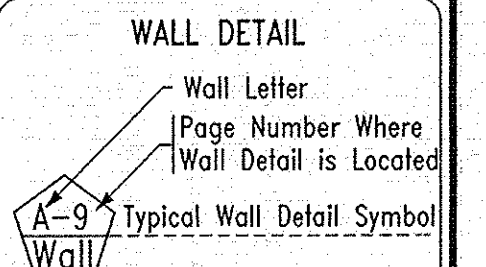
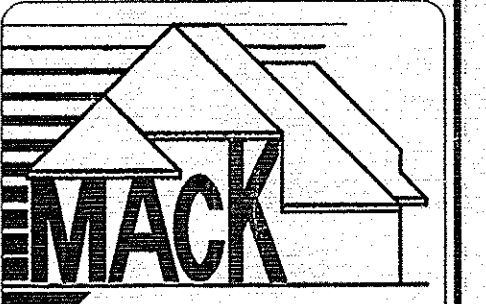

**MACK DESIGN CONSULTANTS**  
 "Designers of Fine Custom Homes"

2808 48 Avenue South  
 Lethbridge, Alberta  
 T1K-7B3

Phone: 403-329-6106  
 Fax: 403-329-3364  
 mackarch@telusplanet.net

- Country Style Home Plans
- City Home Plans
- Additions
- Renovations

**Design Team**  
 Project Designer: Jim Mack  
 Construction Drawings: Rich Mack  
 Preliminary Drawings: Christina Mack

Client: **Hughes**

Scale: 1/4" = 1'-0"

Date: **Oct. 6/06**

Dwg. No.: **0-71-6-2s**

Sheet Title: **Upper Floor Level**

Sheet No.: **3 of 17**

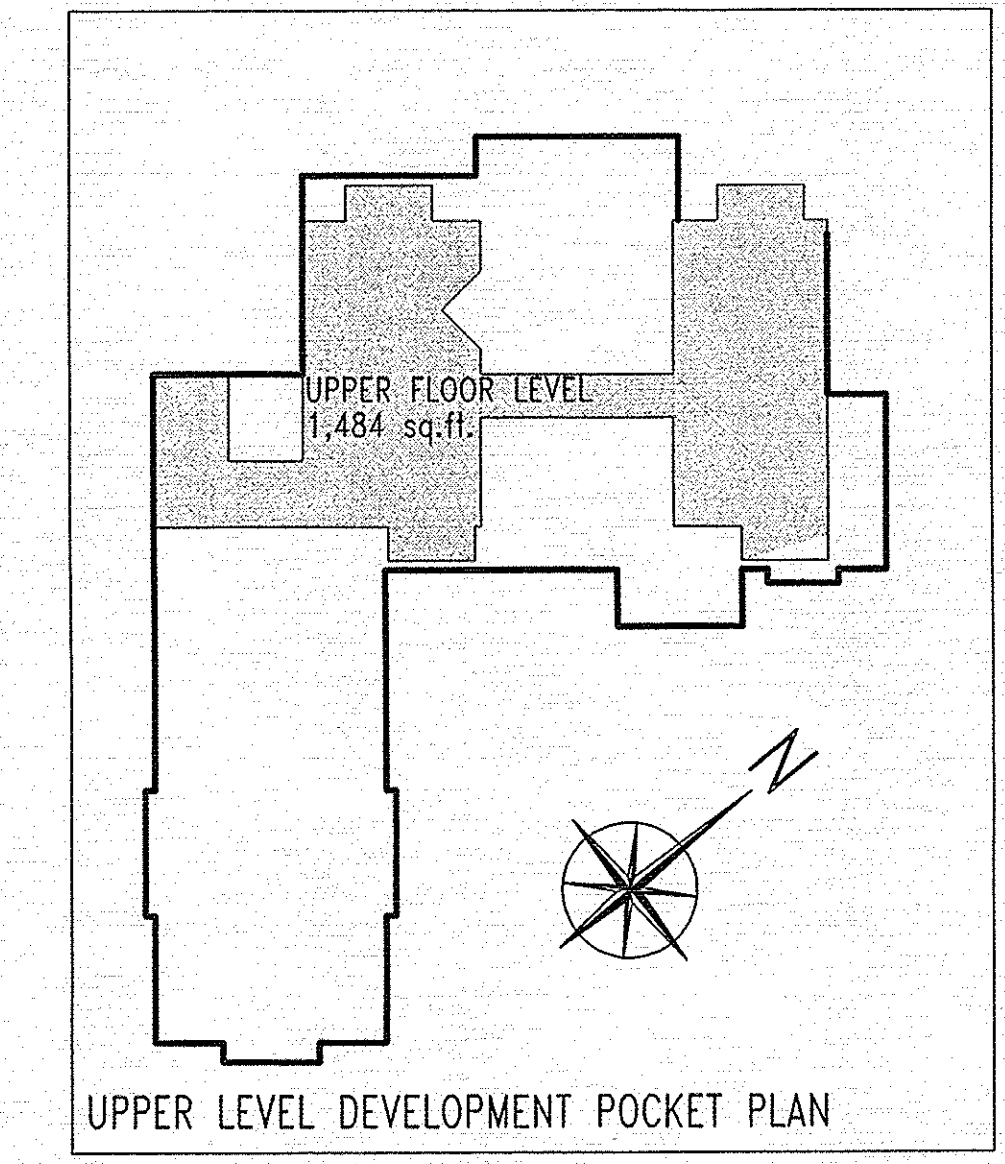

**UPPER LEVEL FLOOR PLAN**

UPPER LEVEL FLOOR 1,484 SQ. FT.  
 MAIN LEVEL FLOOR 2,747 SQ. FT.  
 TWO STOREY HOME 4,231 SQ. FT.

SEE PAGE 10 FOR GENERAL NOTES, LINE TYPE & WALL LEGENDS, PLAN SYMBOLS, WINDOW NOTES

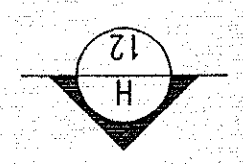
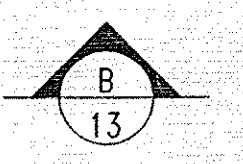
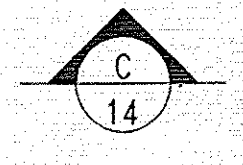
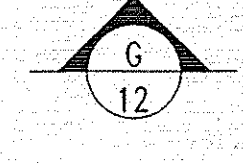
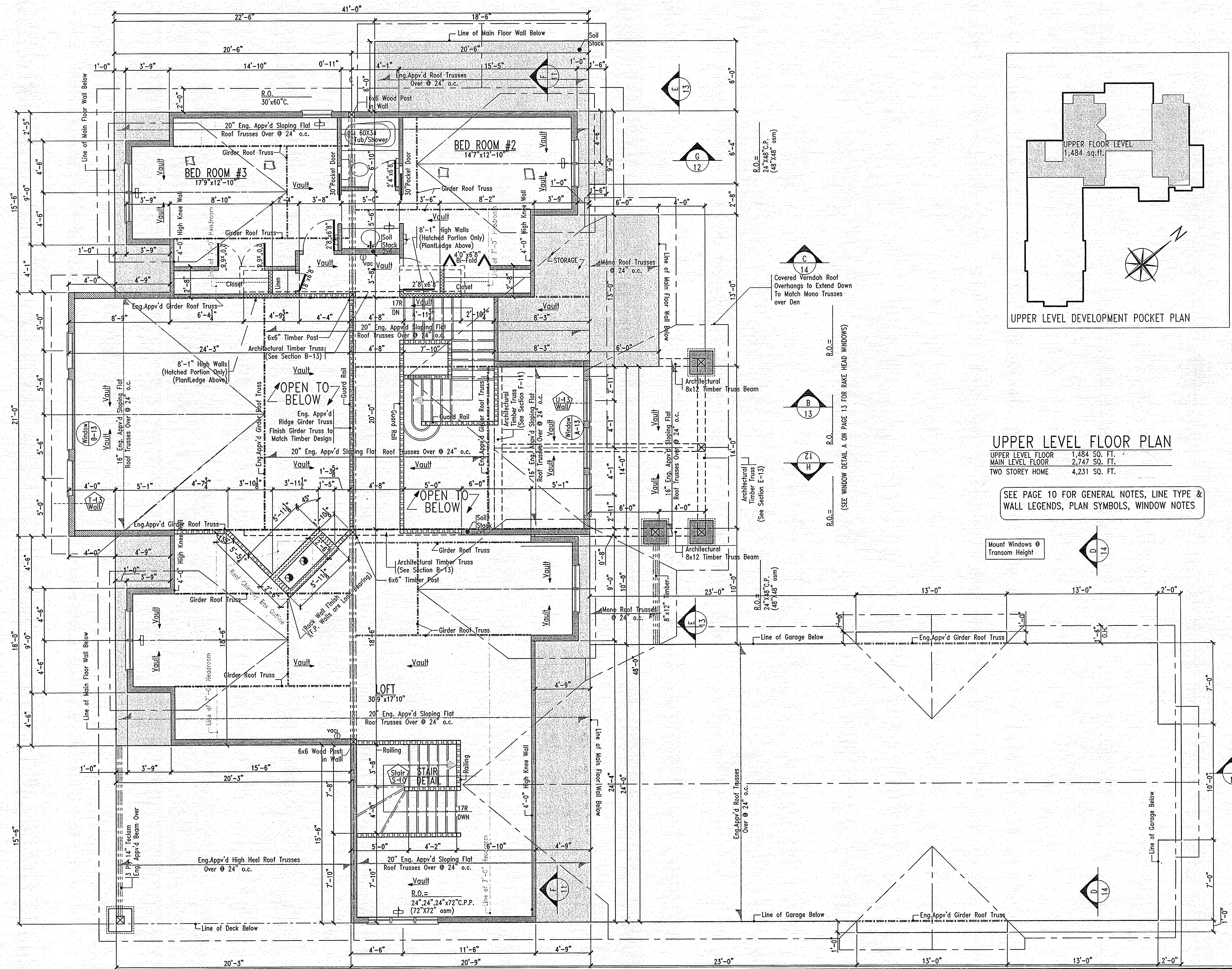

R.O.=  
 30"x48" C.P.  
 (60"x48" osm)

R.O.=  
 (SEE WINDOW DETAIL B ON PAGE 13 FOR RAKE HEAD WINDOWS)

R.O.=  
 30"x48" C.P.  
 (60"x48" osm)

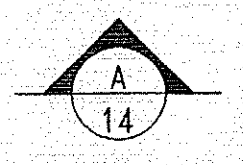

R.O.=  
 24"x48" C.P.  
 (48"x48" osm)

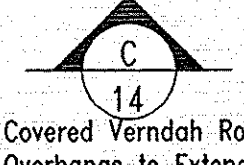

R.O.=  
 (SEE WINDOW DETAIL A ON PAGE 13 FOR RAKE HEAD WINDOWS)

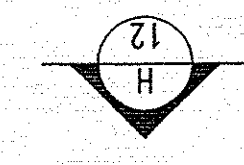
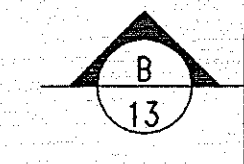

R.O.=  
 24"x48" C.P.  
 (48"x48" osm)

R.O.=  
 24"x48" C.P.  
 (48"x48" osm)

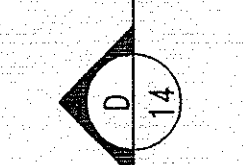

Mount Windows @  
 Transom Height

